

高压离心调频鼓风机

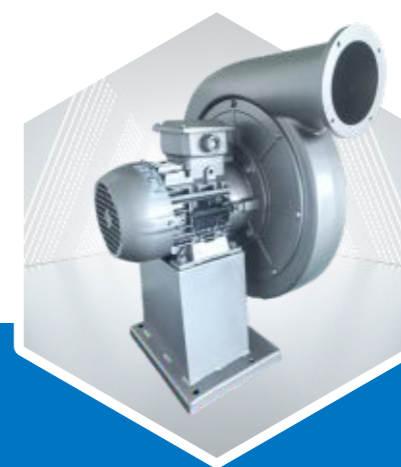

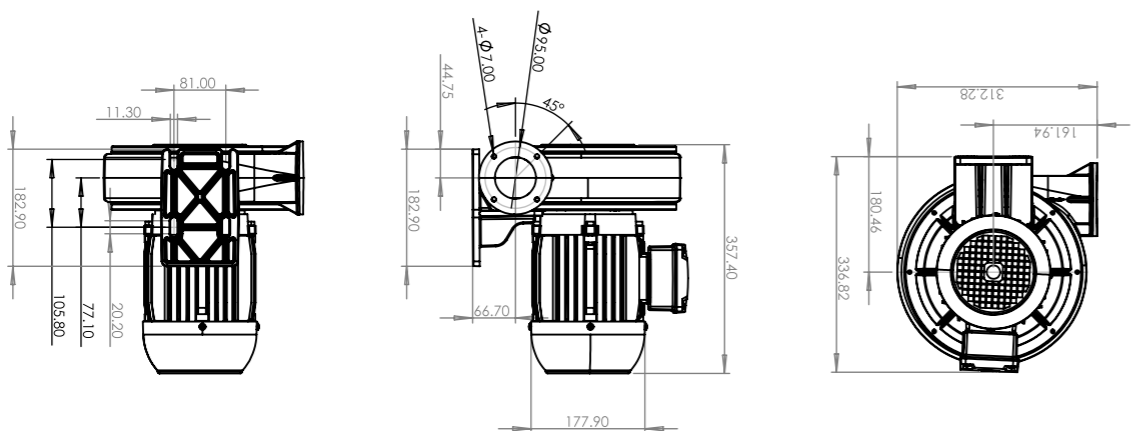

STGY-14T-1.1KW
具体需求型号请联系客服人员

风机型号 Type	气体流量 Volumetric flow rate m³/h	全压差 Toal pressure difference kPa	电压 Voltage V	频率 Frequency Hz	电流 Current consumption A	风机转速 (转/小时) Number of revolutions r/h	电机功率 Motor rating KW	重量 Weight Kg
STGY-14T-1.1KW	470	2.0	400 Δ	60	1.1	3600	1.1	17
	550	3.0	400 Δ	70	1.2	4200	1.1	17
	640	3.5	400 Δ	80	1.5	4800	1.1	17
	720	4.5	400 Δ	90	1.8	5400	1.1	17
	840	6.0	400 Δ	105	2.4	6300	1.1	17

*=必须连接变频器才可以使用 | A variable speed drive must be installed with this blower.

工作曲线 / Characteristic curves

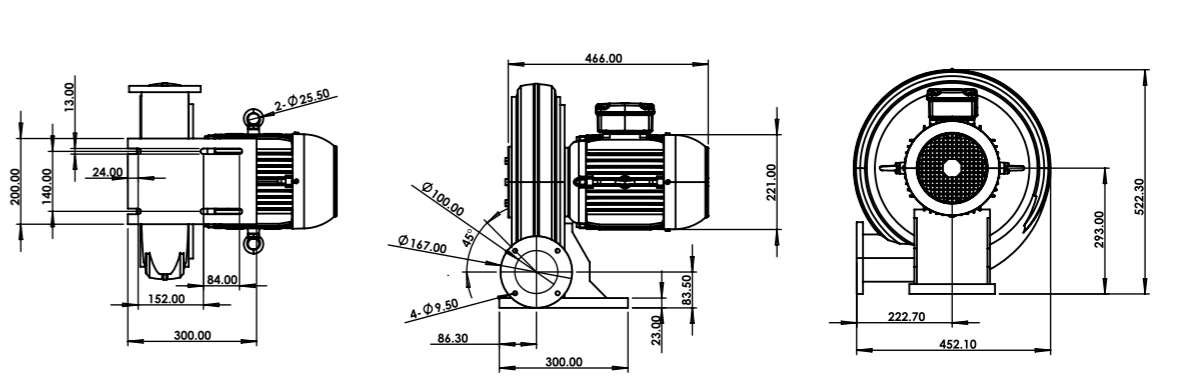
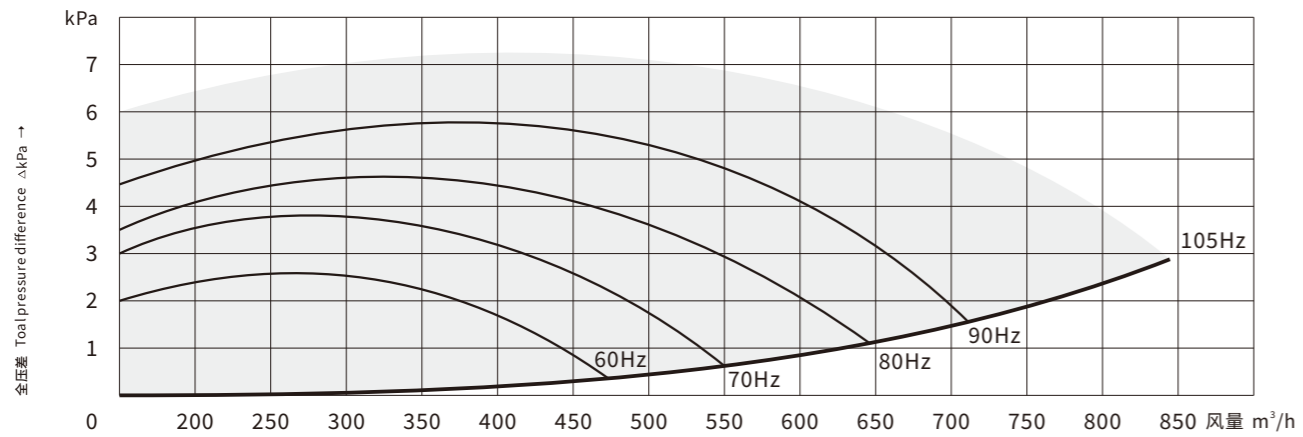

STGY-3T-3KW
具体需求型号请联系客服人员

风机型号 Type	气体流量 Volumetric flow rate m³/h	全压差 Toal pressure difference kPa	电压 Voltage V	频率 Frequency Hz	电流 Current consumption A	风机转速 (转/小时) Number of revolutions r/h	电机功率 Motor rating KW	重量 Weight Kg
STGY-3T-3KW	1214	4.5	400 Δ	60	4.1	3600	3.0	25
	1414	6.0	400 Δ	70	4.8	4200	3.0	25
	1647	8.0	400 Δ	80	5.7	4800	3.0	25
	1857	10.0	400 Δ	90	7.5	5400	3.0	25
	1974	11.0	400 Δ	95	8.7	5700	3.0	25

*=必须连接变频器才可以使用 | A variable speed drive must be installed with this blower.

工作曲线 / Characteristic curves

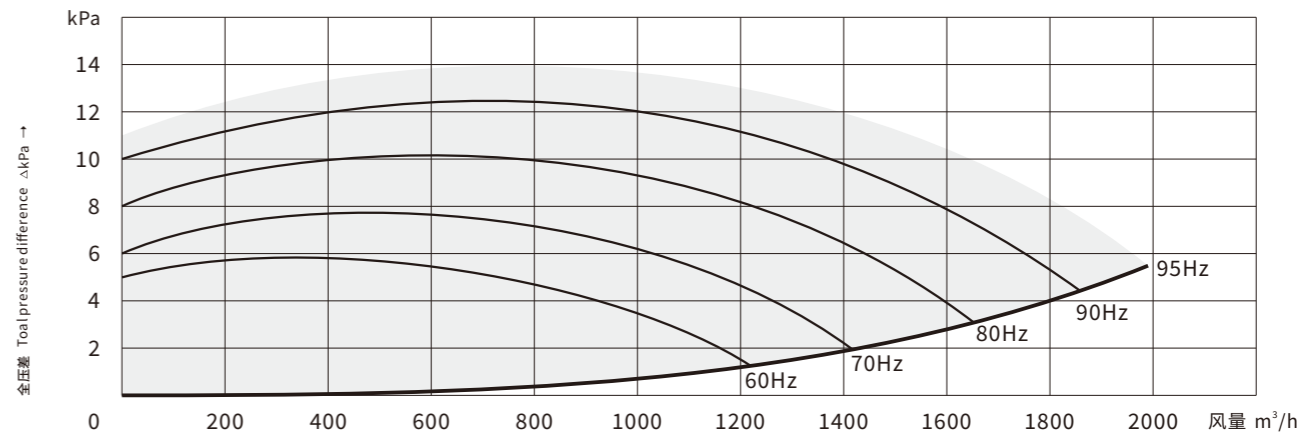

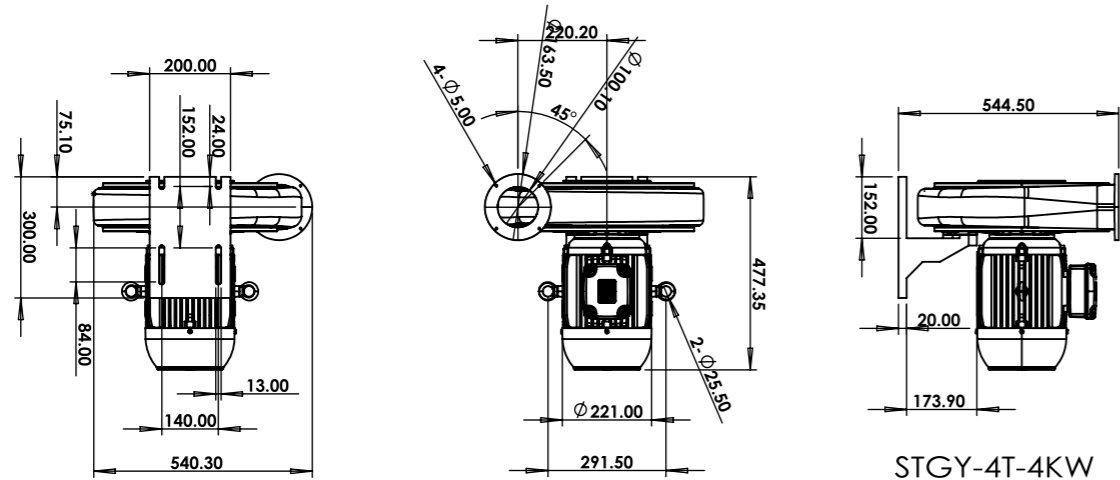

STGY-4T-4KW
具体需求型号请联系客服人员

风机型号 Type	气体流量 Volumetric flow rate m ³ /h	全压差 Toal pressure difference kPa	电压 Voltage V	频率 Frequency Hz	电流 Current consumption A	风机转速 (转/小时) Number of revolutions r/h	电机功率 Motor rating KW	重量 Weight Kg
STGY-4T-4KW	1288	4.5	400 Δ	60	7.2	3600	4.0	35
	1505	5.5	400 Δ	70	8.1	4200	4.0	35
	1740	7.5	400 Δ	80	9.3	4800	4.0	35
	1977	9.0	400 Δ	90	11.2	5400	4.0	35
	2266	12.0	400 Δ	105	14.3	6300	4.0	35

*=必须连接变频器才可以 | A variable speed drive must be installed with this blower.

工作曲线 / Characteristic curves

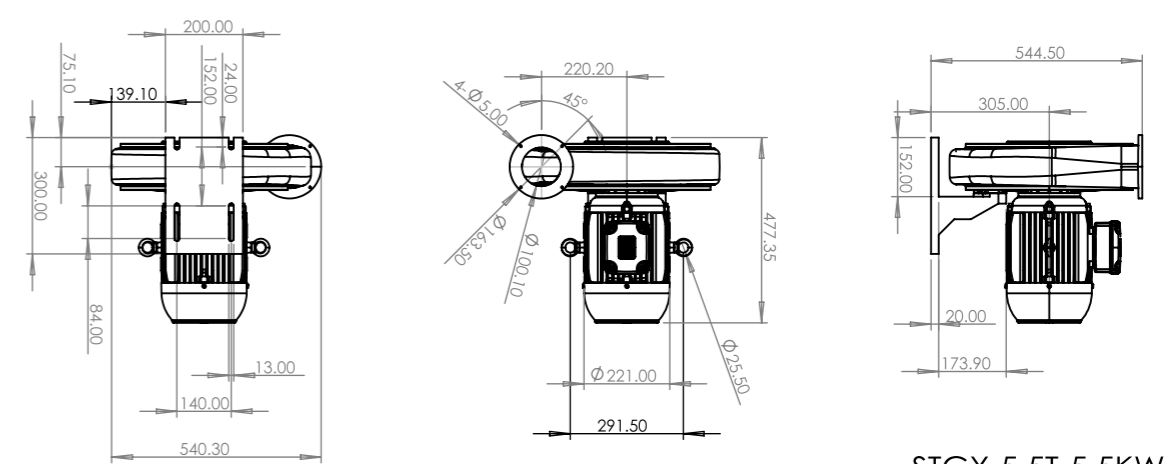
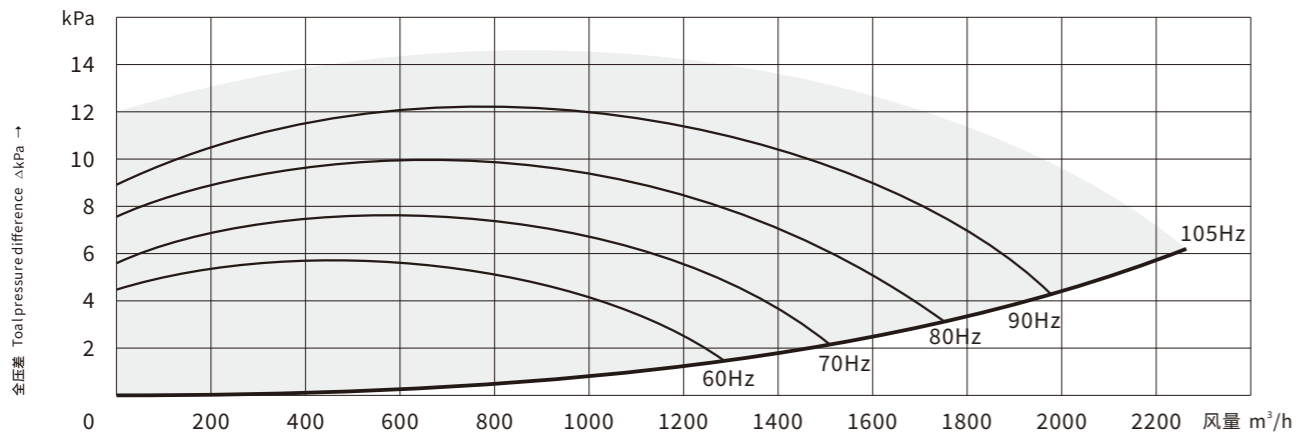

STGY-5.5T-5.5KW
具体需求型号请联系客服人员

风机型号 Type	气体流量 Volumetric flow rate m ³ /h	全压差 Toal pressure difference kPa	电压 Voltage V	频率 Frequency Hz	电流 Current consumption A	风机转速 (转/小时) Number of revolutions r/h	电机功率 Motor rating KW	重量 Weight Kg
STGY-5.5T-5.5KW	1277	4.5	400 Δ	60	7.1	3600	5.5	56
	1522	6.0	400 Δ	70	8.2	4200	5.5	56
	1762	7.5	400 Δ	80	9.7	4800	5.5	56
	2000	10.0	400 Δ	90	11.4	5400	5.5	56
	2289	12.5	400 Δ	105	15.6	6300	5.5	56

*=必须连接变频器才可以 | A variable speed drive must be installed with this blower.

工作曲线 / Characteristic curves

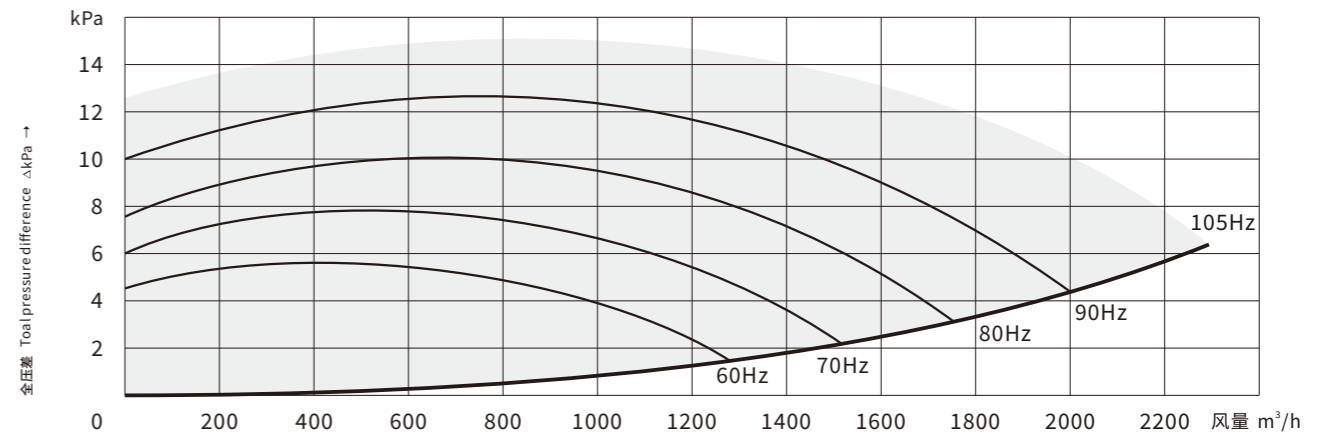

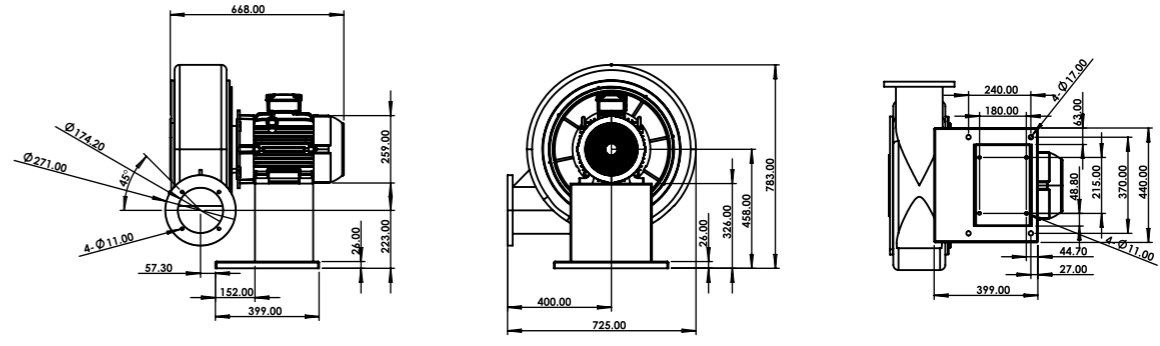
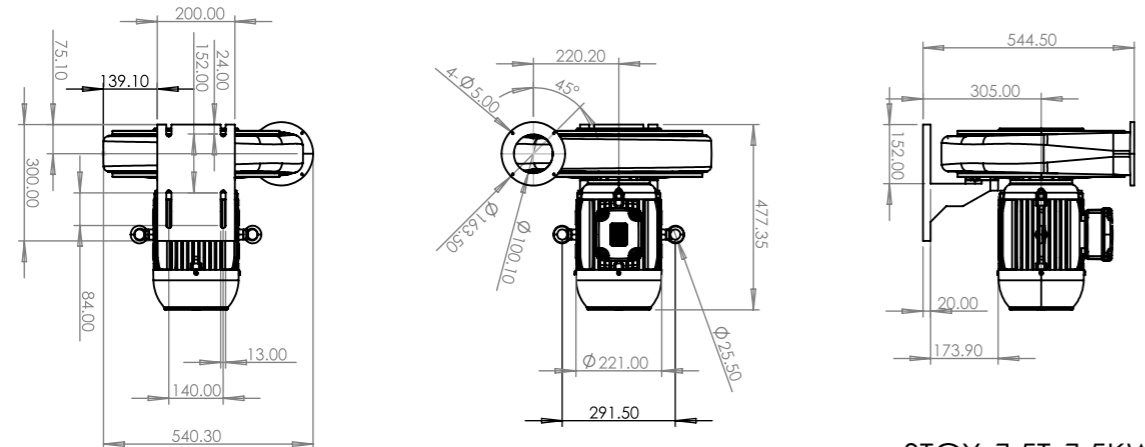

STGY-7.5T-7.5KW
具体需求型号请联系客服人员

STGY-11T-11KW
具体需求型号请联系客服人员

风机型号 Type	气体流量 Volumetric flow rate m ³ /h	全压差 Toal pressure difference kPa	电压 Voltage V	频率 Frequency Hz	电流 Current consumption A	风机转速 (转/小时) Number of revolutions r/h	电机功率 Motor rating KW	重量 Weight Kg
STGY-7.5T-7.5KW	1357	4.5	400 Δ	60	7.7	3600	7.5	60
	1589	6.0	400 Δ	70	8.8	4200	7.5	60
	1828	7.5	400 Δ	80	10.0	4800	7.5	60
	2052	10.0	400 Δ	90	11.6	5400	7.5	60
	2434	12.5	400 Δ	105	15.5	6300	7.5	60

风机型号 Type	气体流量 Volumetric flow rate m ³ /h	全压差 Toal pressure difference kPa	电压 Voltage V	频率 Frequency Hz	电流 Current consumption A	风机转速 (转/小时) Number of revolutions r/h	电机功率 Motor rating KW	重量 Weight Kg
STGY-11T-11KW	2500	—	400 Δ	50	13.2	3600	11.0	92
	3000	7.0	400 Δ	60	17.1	3600	11.0	92
	3500	9.0	400 Δ	70	21.9	4200	11.0	92
	4000	11.0	400 Δ	80	27.7	4800	11.0	92
	4500	14.0	400 Δ	90	34.4	5400	11.0	92
	—	18.0	400 Δ	105	—	—	11.0	92

*=必须连接变频器才可以使用 | A variable speed drive must be installed with this blower.

*=必须连接变频器才可以使用 | A variable speed drive must be installed with this blower.

工作曲线 / Characteristic curves

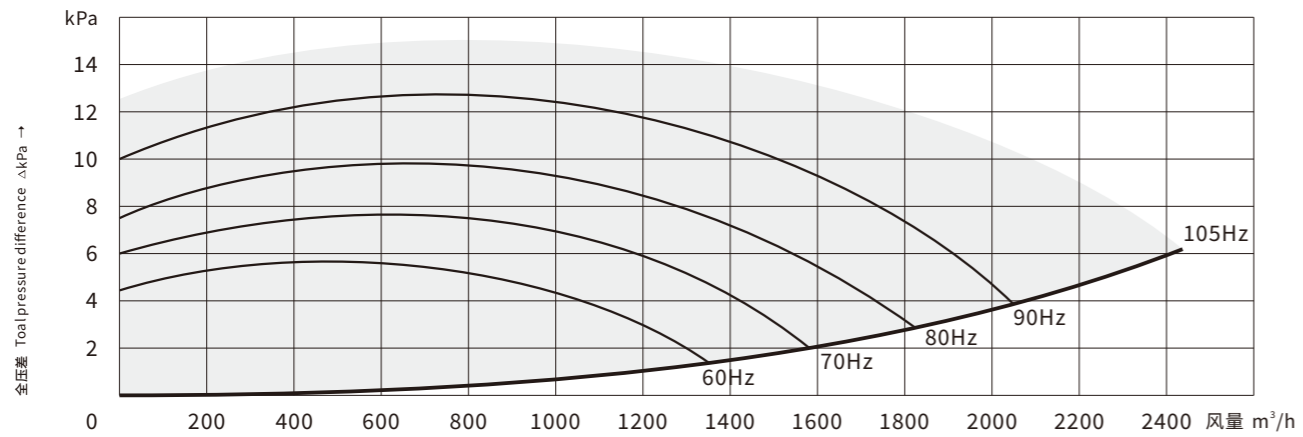

工作曲线 / Characteristic curves

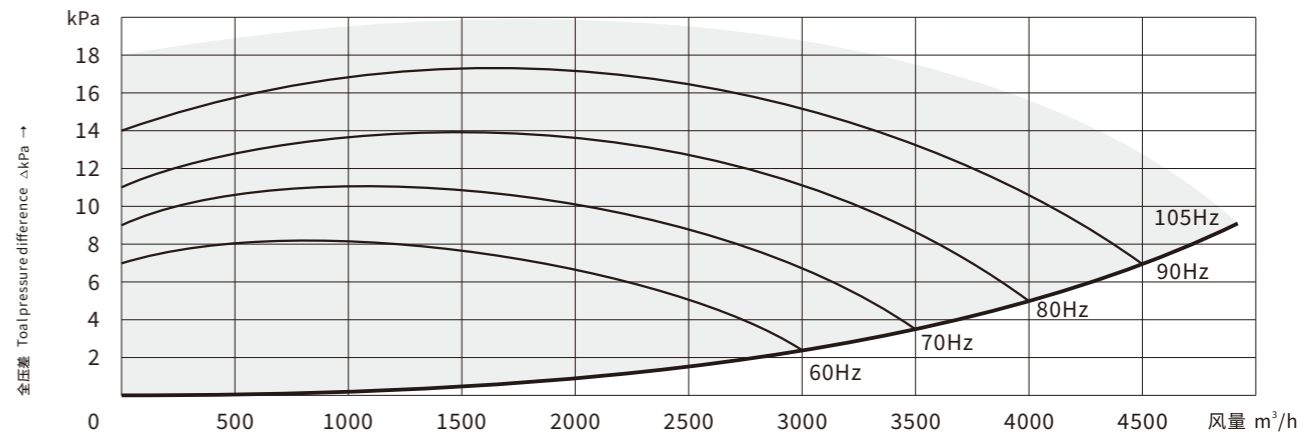

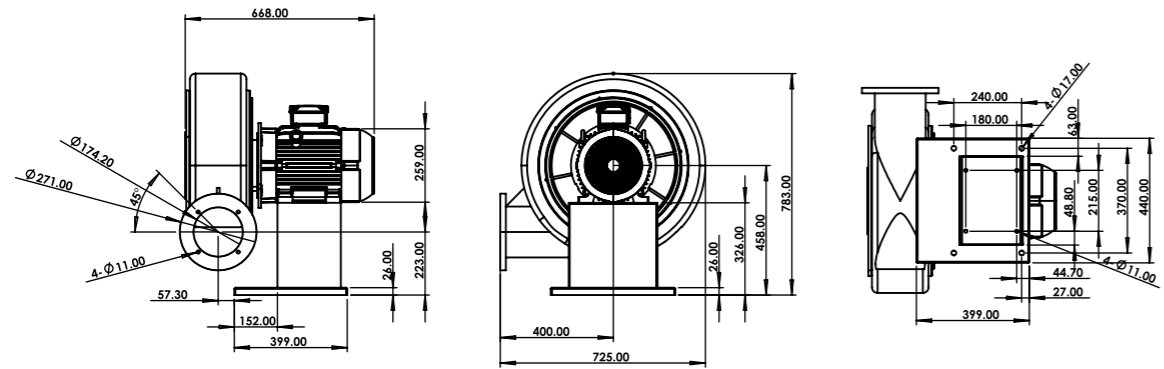

STGY-15T-15KW
具体需求型号请联系客服人员

风机型号 Type	气体流量 Volumetric flow rate m ³ /h	全压差 Total pressure difference kPa	电压 Voltage V	频率 Frequency Hz	电流 Current consumption A	风机转速 (转/小时) Number of revolutions r/h	电机功率 Motor rating KW	重量 Weight Kg
STGY-15T-15KW	3745	7.0	400 Δ	60	19.6	3600	15.0	110
	4361	9.0	400 Δ	70	23.7	4200	15.0	110
	5015	11.0	400 Δ	80	28.5	4800	15.0	110
	5550	14.0	400 Δ	90	35.0	5400	15.0	110
	—	18.0	400 Δ	105	—	—	15.0	110

*=必须连接变频器才可以 | A variable speed drive must be installed with this blower.

工作曲线 / Characteristic curves

